

A photograph of a modern building facade featuring large glass windows and dark, rectangular awnings. The building is set against a clear blue sky. In the foreground, there is a dark grey paved patio area and a swimming pool with green water. The overall aesthetic is clean and contemporary.

ALPHA AWNING

SERIES

*Stylish, Robust &
Energy Efficient.*

WHAT ARE ALPHA AWNINGS?

The Alpha Awning Series has been designed by Australians, specifically for our lifestyles, ensuring design, styling and quality were top of mind. The modern awning series is suited to all exterior buildings.

Featuring 5 matching awning styles, including Cable Guide, Straight Drop, Side Retention System, Pivot Arm and Deep Channel, you can personalise the perfect awning to suit your external shading requirements in 5 easy steps.



STEP 1 AWNING STYLE

Mix and match the awning styles and you can still maintain commonality of appearance and design for your home.



STRAIGHT DROP
Sleek and simple with a modern aesthetic, suitable for the traditional window frames.



CABLE GUIDE
The ultimate industrial look which gives you privacy and allows ventilation.

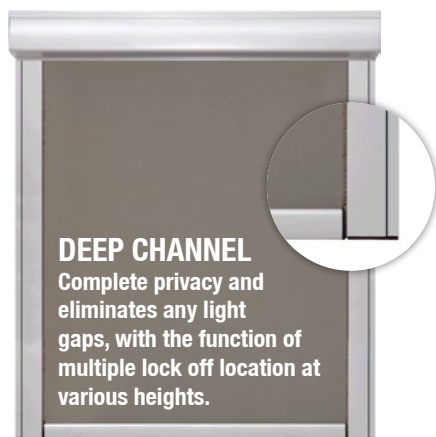

DEEP CHANNEL
Complete privacy and eliminates any light gaps, with the function of multiple lock off location at various heights.



SIDE RETENTION SYSTEM
Ideal for high wind areas. Completely enclosing an outside area, with no gaps for dust and dirt to enter.



PIVOT ARM
Perfect for outward opening windows, to circulate air flow and reduce direct sunlight into the home.

STEP 2 HEADBOX OPTIONS

For a modern contemporary look, the Alpha Awning Series offers two designer headbox options, as well as an open roller option.



CLOSED HEADBOX
Keeps the fabric clean from rain, UV and dirt which assists in enhancing longevity.



OPEN HEADBOX
Increased air circulation around the roller minimising heat build up for PVC skins.



OPEN ROLLER
A modern industrial look and is the ideal choice to reduce costs.

STEP 3 OPERATING OPTIONS

The Alpha Awning Series has been developed to offer maximum flexibility for operation.



INTERNAL CORD WINCH
The Internal Cord Winch is the perfect solution to bring your awning in when the weather is not ideal outside.

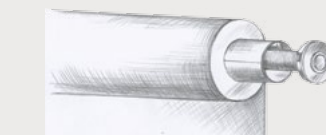

SPRING OPERATION
Allows you to manually adjust the height of the awning and secure using either the sliding bolt system or hold down clip option.

MANUAL CRANK

- The geared crank ensures easy operation that is not dependent on your strength.
- Available in Black, Grey and White for improved colour co-ordination.
- The geared crank handles are available in: 800mm, 1200mm, 1600mm, 2000mm and 2400mm lengths to suit any awning's height.



MOTORISATION
Control your awning with a touch of a button with motorisation. The Alpha Awning Series can be used with the latest Automatic Tensioning Motors that permit awnings to be locked in position (with strap or sliding bolt) and tensioned. This maintains tension on the fabric minimising fabric "blow outs" traditionally caused by unexpected high winds.

The Alpha Awning Series Bottom Rail offers versatility for holding the fabric taut and minimising any movement in windy situations. Not only does it consist of a variety of features, its designed with a subtle modern curve which seamlessly blends with the headbox aesthetics.

STEP 4 ACCESSORIES

WEIGHT BAR

The heavy duty bottom rail has been designed to offer an additional weight bar. This is beneficial for smaller awnings that require additional weight to reduce bottom rail bounce and increase fabric tension.

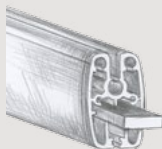

LOCKING BOLT

The locking bolt secures the awning into the universal floor mount bracket or breaching staple.

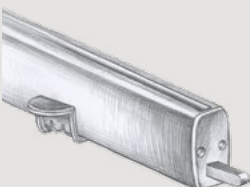

HOLD DOWN STRAP

Hold down straps can be used to hold the awning down at various points across the width of the awning. This option also offers a traditional no guide system where the awning is simply locked into place via straps. Similar to the locking bolts, the hold down clips insert inside the bottom rail for a clean bottom rail finish.

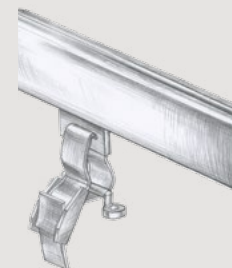

PILE BRUSH AND VALANCE

As experienced in a number of Australian homes, the floor surface is often not perfectly level. Therefore when an awning is installed over a wide width there will be room for light gaps, insects, debris, wind and rain to enter your courtyard or home.

With the ability to insert either pile brush or a fabric valance, this gap can be eliminated therefore maximising the functionality of the awning.

In addition to the protection offered by these inserts they also protect the bottom rail from chipping if dropped to the ground quickly.

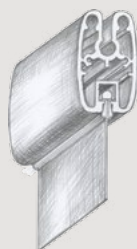

STEP 5 EXTERNAL FABRIC

AIR FLOW

Clear PVC is great for unrestricted view through and when air flow is not an option. If you are enclosing a verandah or patio, consider if you still want to have a nice cool breeze coming through. If this is required, ensure you select an open weave fabric with around 10% openness.

PRIVACY & VIEW THROUGH

There are open and closed weave awning fabrics. Consider if you want day or night time privacy. An open weave fabric in a dark colour gives fantastic view through in the day, but also allows others to see in at night.

DURABILITY

Be mindful that when a fabric is used outdoors it is exposed to the elements. Fabrics with DURAGUARD® Fabric Protector effectively repel most stain causing agents with its proven, water based, preventative formula. This fabric protection is totally invisible and has high levels of stain repellence. It makes cleaning and maintaining the fabric so much easier.

COLOUR FASTNESS

Ensure the fabric you choose has excellent fade resistance to the sun. Any fabric with fade resistance result of 6 and above will ensure your fabric remains the colour you selected for many years to come.

There are numerous choices of awning fabric on the market. When selecting your fabric, keep the following in mind.

- A. MESH
- B. CANVAS
- C. CLEAR PVC
- D. ACRYLIC



Everview External Screen Fabric

The versatile 2x2 weave construction provides a great symmetrical finish and has an additional key functional benefit of being able to railroad the fabric.

Open Roller

A modern industrial look is offered by exposing the componentry. By eliminating the aluminium headbox profiles, the price is significantly reduced.

Straight Drop best suited for...

- Sun/UV protection
- Air flow

Hold Down Straps

Can be used to hold down the awning at various points across the bottom rail and assists in minimising bottom rail movement in stronger winds.

Bottom Rail End Caps

Provide a neat, clean finish for the drop awning giving it a complete, premium look.

ALPHA AWNING

STRAIGHT DROP

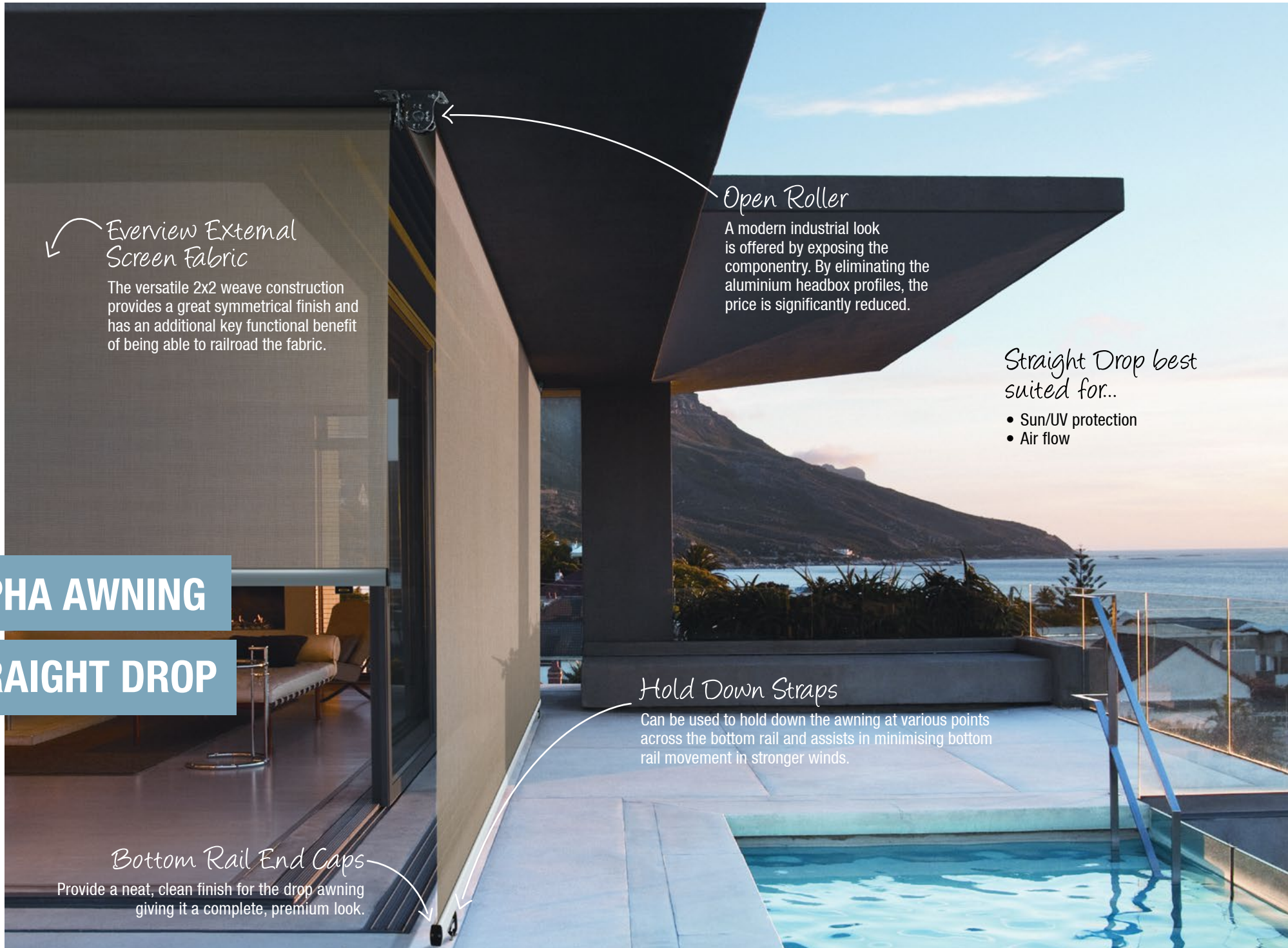

Cable Guide best suited for..

- Sun/UV protection
- Air flow
- Cables are high tensile 2.5mm 316 grade marine stainless steel, making them perfect for coastal applications.

ALPHA AWNING

CABLE GUIDE

*Bottom Rail
End Caps*

By floating in and out of the bottom rail the awning operates smoothly without putting pressure on the cable.





Open Headbox

Increases air circulation around the roller. This minimises heat build up and reduces sticking on clear PVC skins.

Open headbox is ideal for the Pivot Arm Awning.

(Can also be used in front rolled Cable Guide and Straight Drop Awnings.)

Heavy Duty Pivot Arm

The heavy duty spring in the Pivot Arm provides excellent fabric tension, even with awning widths up to 5 metres. The arms are a modern anodised finish that complements the standard Silver Pearl hardware colour. Custom powder coated colours are also available.

ALPHA AWNING

PIVOT ARM

Pivot Arm Feature...

Fabric is projected off the window which allows air to flow behind the Awning. Windows can be open whilst the Awning is projected.

Front Rail

Designed to have the same curve as the Straight Drop bottom rail.

This creates flexibility in being able to mix and match the awnings throughout your home as it holds the design consistency.

SRS best suited for...

- Sun/UV protection
- Insect resistance
- Windy applications
- Enclosing a balcony plus creating privacy
- Light and heat control

Side Channel

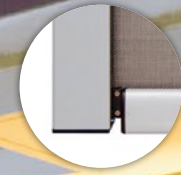

Access to the internal floating channel and fabric is made easy thanks to the two piece side channel. The front channel simply snaps over the installation channel to provide a neat, clean finish, the front channel can also be disconnected.

Benefits...

The fabric is tensioned by utilising a floating channel, located within the special two piece side channel, eliminating the possibility of fabric "blow outs" or light gaps.

As the fabric is held between the left and right channels, this system is ideal for enclosing courtyards, patios or balconies, essentially adding an extra room to the home.

ALPHA AWNING

SIDE RETENTION SYSTEM

(SRS)





ALPHA AWNING

WIND LOAD

The Alpha Awning Series is designed in Australia for Australian conditions. The awnings have been engineered to withstand the harsh Australian climate.

Hunter Douglas Alpha Awnings have been tested to comply with a Class 3 level of Wind Resistance under European standard EN13561: 2009 - 01. This level of Wind Resistance equates to a rating of '6' on the Beaufort Scale, which is equivalent to a wind speed of 49 km/h. It is recommended that all awnings be retracted in windy conditions.

REFLECTS HEAT
KEEPS INTERIORS COOL
REDUCES ENERGY COSTS

ALPHA AWNING

ENERGY SAVING



Proven to significantly reduce cooling costs* throughout summer

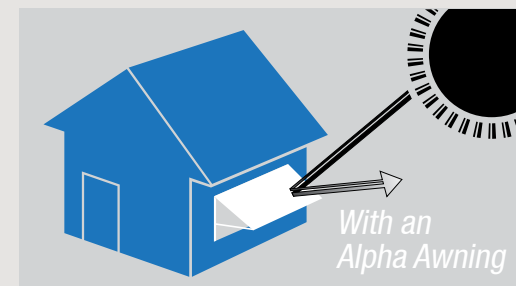
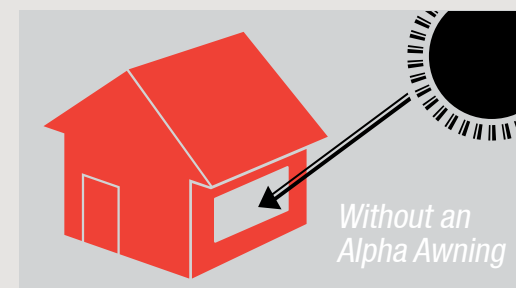
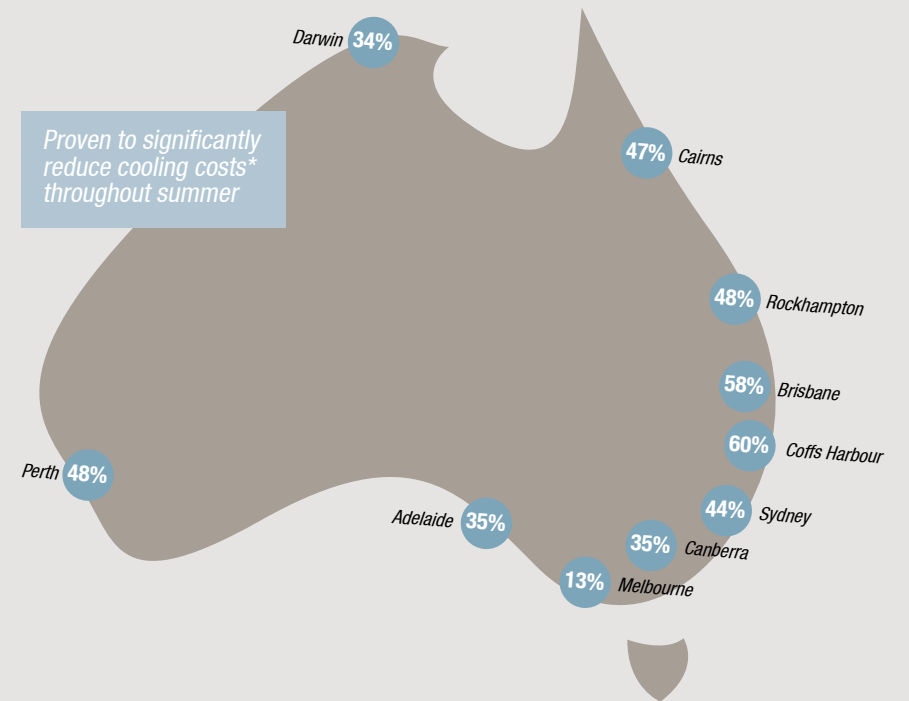

PROVEN TO REDUCE COOLING ENERGY COSTS* BY UP TO 60%

Hunter Douglas Alpha Awnings have been independently tested and proven to significantly reduce cooling energy costs by keeping a standard* home at a consistent and comfortable temperature throughout the summer months.

*Results based on a single storey, brick veneer home on a concrete slab using ducted air-conditioning and equally distributed windows with Alpha Awnings installed with Canvas fabric.

CONTACT US: